

18-126/18-B126 RADIATOR BRACE INSTRUCTIONS

- Remove the seat, radiator shroud, left side tank-to-frame mount bolt and plastic radiator louver.
- Remove the louver's mount slot by trimming its tabs flush with the louver. Reinstall louver and hold it in position. Drill a 1/4" hole as shown in **Figure 1**.
- It will be necessary to remove material from the inside of the radiator shroud where the two interior (rectangular shaped) bosses meet the radiator. Measure down 3/16" from the top edge of the bosses and mark around the entire perimeters with masking tape as shown in **Figure 2**.
- Trim away the 3/16" of material around the entire perimeter of both bosses (area shown between the arrows).
- Insert the 60mm bolt thru the 20mm washer. This will be used as the new tank-to-frame mount fastener.
- Insert the 60mm bolt (with washer) thru the radiator brace and spacer as shown in **Figure 3**.
- Place the radiator into position and tighten the new tank mounting bolt (finger tight for now).
- At the radiator's upper mount flange, insert the 6x14mm bolt thru the radiator brace, the flange and the louver. On the front side of the louver use the 15mm washer and 6mm lock nut to secure the radiator brace to the radiator
- Confirm the radiator brace is in its proper position by centering the mount holes and tighten the upper mount flange bolt to 6ft/lbs.
- Reinstall the radiator shroud and tighten both shroud bolts (first) and then the tank bolt (last) to the OEM specs.
- Install seat.

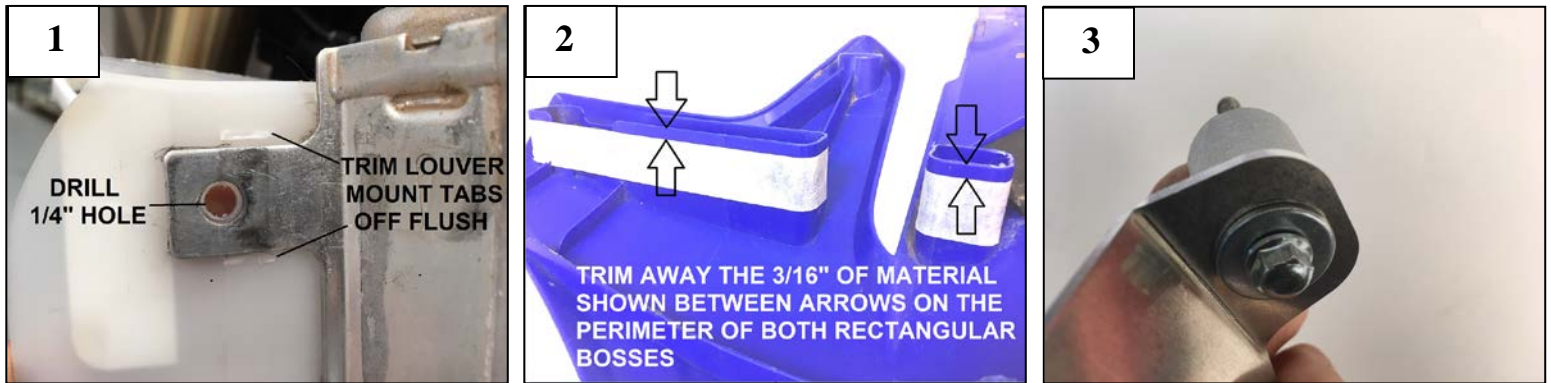

18-126/18-B126 RADIATOR BRACE INSTRUCTIONS

- Remove the seat, radiator shroud, left side tank-to-frame mount bolt and plastic radiator louver.
- Remove the louver's mount slot by trimming its tabs flush with the louver. Reinstall louver and hold it in position. Drill a 1/4" hole as shown in **Figure 1**.
- It will be necessary to remove material from the inside of the radiator shroud where the two interior (rectangular shaped) bosses meet the radiator. Measure down 3/16" from the top edge of the bosses and mark around the entire perimeters with masking tape as shown in **Figure 2**.
- Trim away the 3/16" of material around the entire perimeter of both bosses (area shown between the arrows).
- Insert the 60mm bolt thru the 20mm washer. This will be used as the new tank-to-frame mount fastener.
- Insert the 60mm bolt (with washer) thru the radiator brace and spacer as shown in **Figure 3**.
- Place the radiator into position and tighten the new tank mounting bolt (finger tight for now).
- At the radiator's upper mount flange, insert the 6x14mm bolt thru the radiator brace, the flange and the louver. On the front side of the louver use the 15mm washer and 6mm lock nut to secure the radiator brace to the radiator
- Confirm the radiator brace is in its proper position by centering the mount holes and tighten the upper mount flange bolt to 6ft/lbs.
- Reinstall the radiator shroud and tighten both shroud bolts (first) and then the tank bolt (last) to the OEM specs.
- Install seat.

